

# PALM BREEZE®

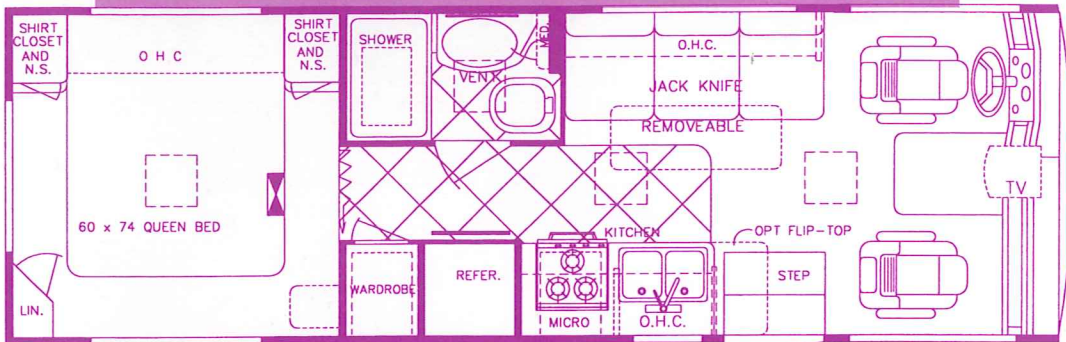

Model 8250

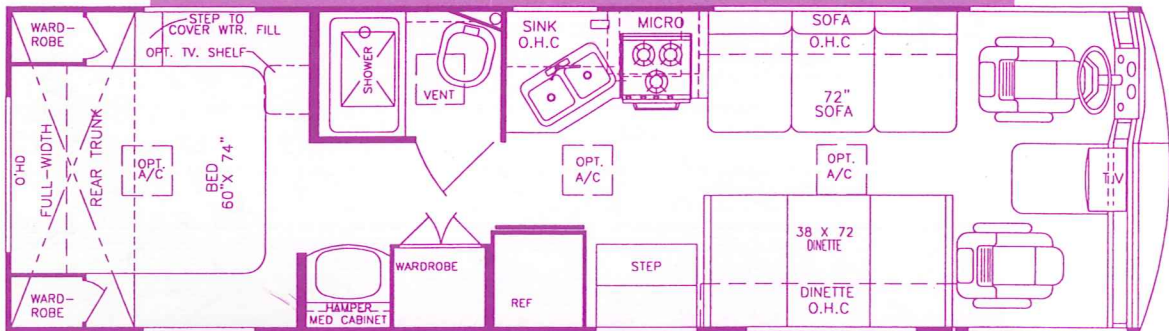

Model 8290

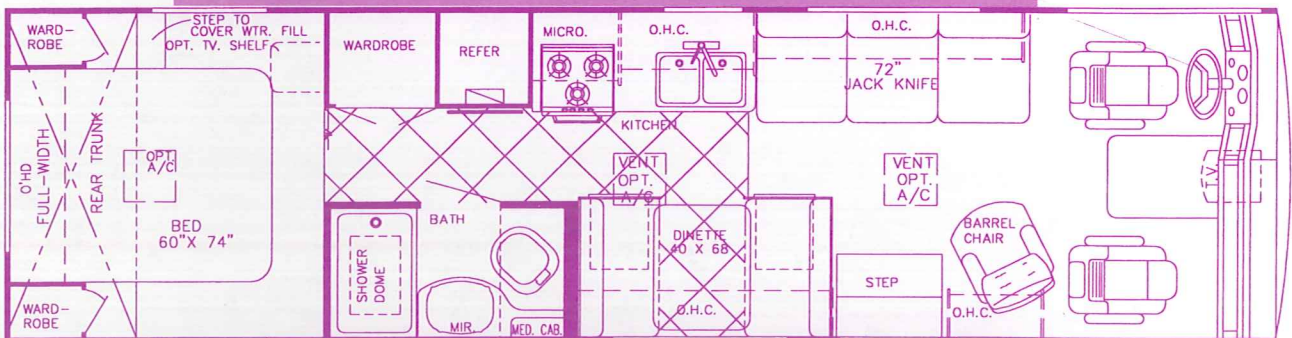

Model 8314



# PALM BREEZE Specifications

## Interior and Decor

- Self-Edged & Radius-Cornered Countertops
- Oak Knife Holder in Kitchen Countertop
- Custom Padded Dash w/ Illuminated Gauges
- Windshield Privacy Drape
- Designer Cloth Cockpit Seats
- Upgrade Deluxe Carpet w/Pad
- Deluxe Quality Furniture
- 3-Way Driver Seat
- Coordinated Bedspread
- Decorative Picture at Dinette
- Generous Overhead Storage
- Extra Large Under Bed Storage
- Mid Door Carpeted Stepwell Cover
- Window Valances

## Exterior and Construction

- **"Cradle of Strength" Construction:**
  - Tubular Steel Cage Construction
  - Welded Steel Truss Sub-Floor
- Vacuum-Bond Laminated Sidewalls
- Block Foam Insulation in Roof & Sidewalls
- Heated & Fully-Enclosed Holding Tanks
- Tri-Mark Exterior Storage Door Latches & Locks
- Radius Entry Door
- Smooth Fiberglass Exterior
- Automotive Style Aluminum Front Grill
- Tinted Windshield and Windows
- Outstanding Exterior Storage
- Deluxe Outside Mirrors
- Seamless Rubber Roof

## Bath and Water

- Demand Water System
- City Water Hook-Up
- Double Stainless Steel Sink
- Tub/Shower combination
- Marine Toilet
- Gravity Drains on Fresh Water Lines
- Skydome in Shower/Bath

## Electrical Systems

- On Dash Emergency Start
- Easy-Access Dual Battery System
- 12-Volt, 45-Amp Converter
- Electric Supply Cord
- Electric Overload Protection
- Generator Compartment
- Automotive-Type, Color-Coded Wiring
- 12-Volt Battery Disconnect

## Heating, Ventilation & Air Conditioning

- 35,000 BTU Ducted Furnace w/Elect. Ign.
- Pre-Wired for Roof A/C

## Deluxe Standard Features

- 19" Color TV w/Remote
- Microwave Oven
- 6 Gal. Elect. Ign. Water Heater
- TV Antenna w/Amp and Boost & 2 Jacks
- Spare Tire
- Wheel Covers
- AM/FM Cassette Stereo w/4 Speakers
- Monitor Panel
- Generator Ready
- Converter w/Battery Charger
- Auto Start Switch

## Chassis

- GM - 454 CID V-8 Engine w/Electronically Shifted 4-Speed Automatic Transmission
- FORD - Super Duty w/460 V-8 and 4-Speed Automatic Transmission
- Electronic Ignition
- Power Steering and Brakes
- High Capacity Automotive Heater & A/C - w/R134 Environmental Refrigerant
- Tilt Steering Wheel
- Cruise Control

## Appliances

- 3-Burner High-Performance Range
- Lighted, Power Range Hood
- 2-Door, 2-Way Refrigerator

| MODEL                          | 8250       | 8290       | 8314       |
|--------------------------------|------------|------------|------------|
| FORD CHASSIS (CID V8 Gas)      | 460        | 460        | 460        |
| Wheelbase                      | 158"       | 190"       | 190"       |
| GVWR                           | 15,200 lb. | 15,200 lb. | 15,200 lb. |
| Front Gross Axle Weight Rating | 5,360 lb.  | 5,360 lb.  | 5,360 lb.  |
| Rear Gross Axle Weight Rating  | 9,880 lb.  | 9,880 lb.  | 9,880 lb.  |
| CHEVY CHASSIS (Vortex)         | 454        | 454        | 454        |
| Wheelbase                      | 190"       | 190"       | 190"       |
| GVWR                           | 14,800 lb. | 14,800 lb. | 14,800 lb. |
| Front Gross Axle Weight Rating | 5,500 lb.  | 5,500 lb.  | 5,500 lb.  |
| Rear Gross Axle Weight Rating  | 10,000 lb. | 10,000 lb. | 10,000 lb. |
| *Exterior Length               | 25' - 10"  | 29' - 8"   | 30' - 10"  |
| *Exterior Height (with A/C)    | 11' - 3"   | 11' - 3"   | 11' - 3"   |
| Overall Width                  | 94"        | 94"        | 94"        |
| Interior Height                | 78"        | 78"        | 78"        |
| Interior Width                 | 91"        | 91"        | 91"        |
| *Fresh Water Tank              | 50 Gal.    | 50 Gal.    | 50 Gal.    |
| *Gray Holding Tank             | 40 Gal.    | 40 Gal.    | 40 Gal.    |
| *Black Holding Tank            | 40 Gal.    | 40 Gal.    | 40 Gal.    |
| Water Heater w/DSI             | 6 Gal.     | 6 Gal.     | 6 Gal.     |
| LP Gas Tank                    | 65 lbs.    | 65/85 lbs. | 65/85 lbs. |
| Fuel Capacity (Ford/GM)        | 75/60 gal. | 75/60 gal. | 75/60 Gal. |
| Furnace (BTU's)                | 25,000     | 35,000     | 35,000     |

\*-Approximate, and subject to change without notice.

For further information, contact your local dealer or Gulf Stream. Gulf Stream Coach, Inc. reserves the right to make changes in prices, colors, materials, components and specifications and to discontinue models at any time without notice or obligation. Gulf Stream Coach, Inc. assumes no responsibility for any error in type or print reproduction of specifications or floorplans in this brochure.

TP 10M 12/97



For More Information, Call  
1-800-289-8787, ext. 3288

Visit our Web Site at:  
[www.GULFSTREAMCOACH.com](http://www.GULFSTREAMCOACH.com)

GULF STREAM COACH, INC.  
P.O. BOX 1005 • NAPPANEE, IN 46550